

CERAMIC NOZZLE 950-CER

The ceramic nozzle type 950-cer was designed for the hand lance use. The mvt ceramic nozzles have a efficiency factor of 0.95. The advantages come to the fore especially in concrete removal, such as exposing rebars, or in depth removal. A big advantage is that the ceramicinsert can not burst and also the lifetime is much more higher than sapphire. Due to its advantageous shape, this nozzle can easily be mounted on all conventional hand lances with an inner cone.

The ceramic insert has a uniform and high quality. All inserts are checked for scratches, cracks and flow.

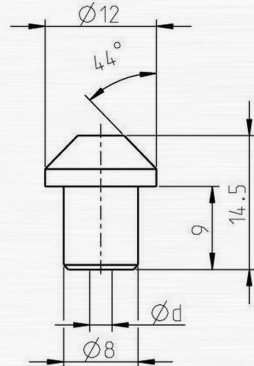

CHARACTERISTICS	TYPE
Operating pressure (bar)	max. 3000
Operating temp. (°C)	max. 150°

PROPERTIES AND ADVANTAGES

- LONG LIFETIME
- CONSTANT JET QUALITY
- HIGH-POWER AND FOCUSED WATER JET
- NEEDLE JET WITH HIGH ENERGY DENSITY
- EASY TO INSTALL AND DISASSEMBLE
- SWISS QUALITY

APPLICATIONS

- CONSTRUCTION INDUSTRY
- MINING
- CONCRETE DEMOLITION
- SURFACE TREATMENT

CERAMIC NOZZLE 950-CER

PERFORMANCES

ART. NO	NOZZLE SIZE IN US GAL/MIN AT 40 PSI	NOZZLE ØD MM	PRESSURE IN PSI / BAR					
			psi	psi	psi	psi	psi	psi
			14500	21750	25375	29000	36250	43500
			bar	bar	bar	bar	bar	bar
			1000	1500	1750	2000	2500	3000
			FLOW RATE IN L/MIN					
950-CER.060	0097	0.60	7.074	8.596	9.250	9.852	10.937	11.901
950-CER.065	0114	0.65	8.303	10.088	10.855	11.562	12.836	13.967
950-CER.070	0132	0.70	9.629	11.700	12.590	13.409	14.886	16.198
950-CER.075	0152	0.75	11.054	13.431	14.452	15.393	17.089	18.595
950-CER.080	0173	0.80	12.577	15.282	16.444	17.514	19.443	21.157
950-CER.085	0195	0.85	14.198	17.252	18.563	19.772	21.950	23.884
950-CER.090	0219	0.90	15.917	19.341	20.811	22.166	24.608	26.777
950-CER.095	0244	0.95	17.735	21.550	23.188	24.698	27.418	29.835
950-CER.100	0270	1.00	19.651	23.878	25.693	27.366	30.380	33.058
950-CER.105	0298	1.05	21.665	26.325	28.327	30.171	33.494	36.446
950-CER.110	0327	1.10	23.778	28.892	31.089	33.113	36.760	40.000
950-CER.115	0358	1.15	25.989	31.578	33.979	36.191	40.177	43.719
950-CER.120	0389	1.20	28.298	34.384	36.998	39.407	43.747	47.603
950-CER.130	0457	1.30	33.211	40.353	43.421	46.248	51.342	55.867
950-CER.140	0530	1.40	38.516	46.800	50.359	53.637	59.545	64.793

INSTRUCTIONS

WHEN MANUALLY OPERATING HIGH PRESSURE GUNS AND LANCES THE REPULSIVE FORCE ON THE AXIS SHOULD NOT EXCEED 250N! IF THE REPULSIVE FORCE EXCEEDS 150N, A SUPPORT / BODY ARMOUR IS REQUIRED!

	< 150 N
	< 250 N
	> 250 N



Jan van der Heijdenstraat 44
3261 LE Oud-Beijerland
The Netherlands

T +31 186 62 14 84
info@salotech.nl
www.salotech.nl