

CERAMIC NOZZLE 952-CER

The ceramic nozzle type 952-cer was designed for the hand lance use. The mvt ceramic nozzles have a efficiency factor of 0.95. The advantages come to the fore especially in concrete removal, such as exposing rebars, or in depth removal. A big advantage is that the ceramic insert can not burst and also the lifetime is much more higher than sapphire. Due to its advantageous shape, this nozzle can easily be mounted on all conventional hand lances with an outer cone.

The ceramic insert has a uniform and high quality. All inserts are checked for scratches, cracks and flow.

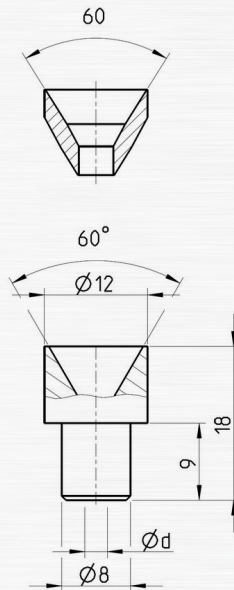

CHARACTERISTICS	TYPE
Operating pressure (bar)	max. 3000
Operating temp. (°C)	max. 150°

PROPERTIES AND ADVANTAGES

- LONG LIFETIME
- CONSTANT JET QUALITY
- HIGH-POWER AND FOCUSED WATER JET
- NEEDLE JET WITH HIGH ENERGY DENSITY
- EASY TO INSTALL AND DISASSEMBLE
- SWISS QUALITY

APPLICATIONS

- CONSTRUCTION INDUSTRY
- MINING
- CONCRETE DEMOLITION
- SURFACE TREATMENT

CERAMIC NOZZLE 952-CER

PERFORMANCES

ART. NO	NOZZLE SIZE IN US GAL/MIN AT 40 PSI	NOZZLE ØD MM	PRESSURE IN PSI / BAR							
			psi 14500	psi 21750	psi 25375	psi 29000	psi 31900	psi 36250	psi 43500	
			bar 1000	bar 1500	bar 1750	bar 2000	bar 2200	bar 2500	bar 3000	
FLOW RATE IN L/MIN										
952-CER.060	0097	0.60	7.074	8.596	9.250	9.852	10.303	10.937	11.901	
952-CER.065	0114	0.65	8.303	10.088	10.855	11.562	12.092	12.836	13.967	
952-CER.070	0132	0.70	9.629	11.700	12.590	13.409	14.023	14.886	16.198	
952-CER.075	0152	0.75	11.054	13.431	14.452	15.393	16.098	17.089	18.595	
952-CER.080	0173	0.80	12.577	15.282	16.444	17.514	18.316	19.443	21.157	
952-CER.085	0195	0.85	14.198	17.252	18.563	19.772	20.677	21.950	23.884	
952-CER.090	0219	0.90	15.917	19.341	20.811	22.166	23.181	24.608	26.777	
952-CER.095	0244	0.95	17.735	21.550	23.188	24.698	25.829	27.418	29.835	
952-CER.100	0270	1.00	19.651	23.878	25.693	27.366	28.619	30.380	33.058	
952-CER.105	0298	1.05	21.665	26.325	28.327	30.171	31.552	33.494	36.446	
952-CER.110	0327	1.10	23.778	28.892	31.089	33.113	34.629	36.760	40.000	
952-CER.120	0389	1.20	28.298	34.384	36.998	39.407	41.211	43.747	47.603	
952-CER.130	0457	1.30	33.211	40.353	43.421	46.248	48.366	51.342	55.867	
952-CER.130	0530	1.40	38.516	46.800	50.359	53.637	56.093	59.545	64.793	

Gasket Sold Separately

ART. NO.	MATERIAL	MAX. PRESSURE (BAR)
10166	Steel Inox	3000

	< 150 N
	< 250 N
	> 250 N

INSTRUCTIONS

WHEN MANUALLY OPERATING HIGH PRESSURE GUNS AND LANCES THE REPULSIVE FORCE ON THE AXIS SHOULD NOT EXCEED 250N! IF THE REPULSIVE FORCE EXCEEDS 150N, A SUPPORT / BODY ARMOUR IS REQUIRED!



Jan van der Heijdenstraat 44
3261 LE Oud-Beijerland
The Netherlands

T +31 186 62 14 84
info@salotech.nl
www.salotech.nl