

# SAPPHIRE INSERT NOZZLE 950

The high-performance sapphire nozzle type 950 was designed for hand lances. The nozzle is characterized above all by its service life, efficiency and quality and can be used up to an operating pressure of 3000 bar. Due to its advantageous shape, this nozzle can easily be mounted on a hand lance with inner cone.

This product is compatible with the following brands or products.  
- Typ K

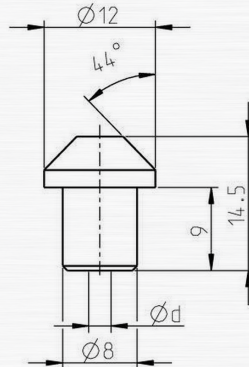

## PROPERTIES AND ADVANTAGES

- LONG LIFETIME
- CONSTANT JET QUALITY
- HIGH-POWER AND FOCUSED WATER JET
- NEEDLE JET WITH HIGH ENERGY DENSITY
- EASY TO INSTALL AND DISASSEMBLE
- SWISS QUALITY

## APPLICATIONS

- CONSTRUCTION INDUSTRY
- CONCRETE DEMOLITION
- SURFACE TREATMENT
- OFFSHORE DEPLOYMENT

CHARACTERISTICS	TYPE
Operating pressure (bar)	max. 3000
Operating temp. (°C)	max. 150°

# SAPPHIRE INSERT NOZZLE 950

## PERFORMANCES

ART. NO	NOZZLE SIZE IN US GAL/MIN AT 40 PSI	NOZZLE ØD MM	PRESSURE IN PSI / BAR						
			psi	psi	psi	psi	psi	psi	
			7250	10875	14500	21750	29000	36250	43500
			bar	bar	bar	bar	bar	bar	bar
			500	750	1000	1500	2000	2500	3000
			FLOW RATE IN L/MIN						
950.010	0002	0.10	0.100	0.122	0.141	0.171	0.196	0.217	0.237
950.0125	0003	0.125	0.157	0.191	0.220	0.267	0.306	0.340	0.370
950.015	0004	0.15	0.226	0.275	0.316	0.385	0.441	0.489	0.532
950.0175	0006	0.175	0.307	0.375	0.431	0.523	0.600	0.666	0.725
950.020	0008	0.20	0.401	0.489	0.563	0.684	0.784	0.870	0.946
950.025	0012	0.25	0.627	0.764	0.879	1.068	1.224	1.359	1.479
950.030	0018	0.30	0.903	1.101	1.266	1.538	1.763	1.957	2.130
950.035	0025	0.35	1.265	1.542	1.774	2.155	2.470	2.742	2.984
950.040	0032	0.40	1.652	2.015	2.317	2.815	3.226	3.582	3.897
950.045	0041	0.45	2.091	2.550	2.932	3.563	4.083	4.533	4.933
950.050	0050	0.50	2.581	3.148	3.620	4.399	5.041	5.596	6.090
950.055	0061	0.55	3.123	3.809	4.380	5.322	6.100	6.772	7.368
950.060	0072	0.60	3.717	4.533	5.213	6.334	7.259	8.059	8.769
950.065	0085	0.65	4.362	5.320	6.118	7.434	8.519	9.458	10.291
950.070	0098	0.70	5.059	6.170	7.095	8.621	9.881	10.969	11.936
950.075	0113	0.75	5.808	7.083	8.145	9.897	11.342	12.592	13.702
950.080	0130	0.80	6.702	8.174	9.399	11.421	13.090	14.531	15.812
950.085	0147	0.85	7.566	9.228	10.611	12.893	14.777	16.404	17.850
950.090	0165	0.90	8.483	10.345	11.896	14.455	16.566	18.391	20.012
950.095	0186	0.95	9.584	11.689	13.441	16.332	18.718	20.780	22.611
950.100	0207	1.00	10.620	12.952	14.894	18.097	20.740	23.025	25.054
950.110	0250	1.10	12.850	15.671	18.021	21.897	25.096	27.860	30.316
950.120	0297	1.20	15.293	18.650	21.447	26.059	29.866	33.156	36.078
950.130	0349	1.30	17.947	21.888	25.170	30.584	35.051	38.912	42.342
950.140	0405	1.40	20.815	25.385	29.191	35.470	40.651	45.129	49.106
950.150	0465	1.50	23.895	29.141	33.510	40.718	46.666	51.806	56.372
950.160	0536	1.60	27.564	33.616	38.657	46.971	53.833	59.762	65.030
950.170	0605	1.70	31.118	37.950	43.640	53.026	60.772	67.466	73.412
950.180	0679	1.80	34.886	42.546	48.925	59.448	68.132	75.636	82.303
950.190	0756	1.90	38.870	47.404	54.512	66.237	75.913	84.274	91.702
950.200	0861	2.00	44.249	53.965	62.056	75.404	86.418	95.937	104.393
950.210	0974	2.10	50.086	61.083	70.242	85.349	97.817	108.591	118.162
950.220	1097	2.20	56.397	68.780	79.093	96.104	110.143	122.274	133.052
950.230	1199	2.30	61.641	75.175	86.447	105.040	120.384	133.643	145.422
950.240	1306	2.40	67.117	81.854	94.127	114.372	131.080	145.517	158.343
950.250	1417	2.50	72.827	88.817	102.135	124.102	142.230	157.896	171.813

# SAPPHIRE INSERT NOZZLE 950

## PERFORMANCES

ART. NO	NOZZLE SIZE IN US GAL/MIN AT 40 PSI	NOZZLE ØD MM	PRESSURE IN PSI / BAR								
			psi	psi	psi	psi	psi	psi	psi		
			7250	10875	14500	21750	29000	36250	43500		
			bar	bar	bar	bar	bar	bar	bar	bar	
			500	750	1000	1500	2000	2500	3000		
			FLOW RATE IN L/MIN								
950.260	1532	2.60	78.770	96.064	110.469	134.228	153.836	170.780	185.833		
950.270	1653	2.70	84.945	103.596	119.130	144.752	165.898	184.170	200.402		
950.280	1777	2.80	91.354	111.412	128.118	155.673	178.414	198.064	215.522		
950.290	1906	2.90	97.996	119.512	137.432	166.991	191.385	212.465	231.191		
950.300	2040	3.00	104.871	127.896	147.074	178.707	204.812	227.370	247.410		

### INSTRUCTIONS

WHEN MANUALLY OPERATING HIGH PRESSURE GUNS AND LANCES THE REPULSIVE FORCE ON THE AXIS SHOULD NOT EXCEED 250N! IF THE REPULSIVE FORCE EXCEEDS 150N, A SUPPORT / BODY ARMOUR IS REQUIRED!

	< 150 N
	< 250 N
	> 250 N



Jan van der Heijdenstraat 44  
3261 LE Oud-Beijerland  
The Netherlands

T +31 186 62 14 84  
info@salotech.nl  
www.salotech.nl