

SAPPHIRE NOZZLE SN716

The high-performance Sapphire nozzle type SN716 is designed for surface treatment. The nozzle is characterized above all by its service life, efficiency and quality. This nozzle was designed for the rotary nozzle Barracuda® from Stoneage.

The heart of the nozzle, its the sapphire has a consistent and high quality. All sapphire are checked for scratches, cracks and flow.

This product is compatible with the following brands or products.

- OS7™

PROPERTIES AND ADVANTAGES

- LONG LIFETIME
- CONSTANT JET QUALITY
- HIGH-POWER AND FOCUSED WATER JET
- NEEDLE JET WITH HIGH ENERGY DENSITY
- EASY TO INSTALL AND DISASSEMBLE
- SWISS QUALITY

APPLICATIONS

- CONSTRUCTION INDUSTRY
- MINING
- CONCRETE DEMOLITION
- SURFACE TREATMENT
- CEMENT AND CONCRETE INDUSTRY
- INDUSTRIAL CLEANING
- SPRAYBARS

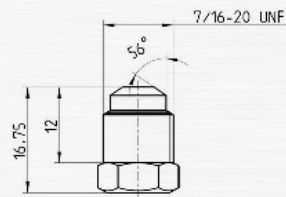
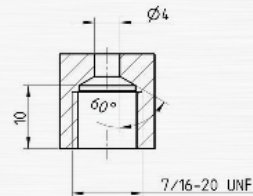

CHARACTERISTICS	TYPE
	976
Operating pressure (bar)	max. 3000
Operating temp. (°C)	max. 150°
Tightening torque (Nm)	max. 40°

SAPPHIRE NOZZLE SN716

PERFORMANCES

ART. NO	NOZZLE SIZE IN US GAL/MIN AT 40"PSI	NOZZLE ØID MM	PRESSURE IN PSI / BAR								
			psi 2900	psi 7250	psi 10875	psi 14500	psi 21750	psi 29000	psi 36250	psi 43500	
			bar 200	bar 500	bar 750	bar 1000	bar 1500	bar 2000	bar 2500	bar 3000	
			FLOW RATE IN L/MIN								
SN716.010	0002	0.10	0.064	0.100	0.122	0.141	0.171	0.196	0.217	0.237	
SN716.0125	0003	0.125	0.100	0.157	0.191	0.220	0.267	0.306	0.340	0.370	
SN716.015	0004	0.15	0.143	0.226	0.275	0.316	0.385	0.441	0.489	0.532	
SN716.0175	0006	0.175	0.195	0.307	0.375	0.431	0.523	0.600	0.666	0.725	
SN716.020	0008	0.20	0.255	0.401	0.489	0.563	0.684	0.784	0.870	0.946	
SN716.025	0012	0.25	0.399	0.627	0.764	0.879	1.068	1.224	1.359	1.479	
SN716.030	0018	0.30	0.574	0.903	1.101	1.266	1.538	1.763	1.957	2.130	
SN716.035	0025	0.35	0.804	1.265	1.542	1.774	2.155	2.470	2.742	2.984	
SN716.040	0032	0.40	1.050	1.652	2.015	2.317	2.815	3.226	3.582	3.897	
SN716.045	0041	0.45	1.329	2.091	2.550	2.932	3.563	4.083	4.533	4.933	
SN716.050	0050	0.50	1.641	2.581	3.148	3.620	4.399	5.041	5.596	6.090	
SN716.055	0061	0.55	1.986	3.123	3.809	4.380	5.322	6.100	6.772	7.368	
SN716.060	0073	0.60	2.363	3.717	4.533	5.213	6.334	7.259	8.059	8.769	
SN716.065	0085	0.65	2.773	4.362	5.320	6.118	7.434	8.519	9.458	10.291	
SN716.070	0099	0.70	3.217	5.059	6.170	7.095	8.621	9.881	10.969	11.936	
SN716.075	0114	0.75	3.692	5.808	7.083	8.145	9.897	11.342	12.592	13.702	
SN716.080	0131	0.80	4.261	6.702	8.174	9.399	11.421	13.090	14.531	15.812	
SN716.085	0148	0.85	4.810	7.566	9.228	10.611	12.893	14.777	16.404	17.850	
SN716.090	0166	0.90	5.393	8.483	10.345	11.896	14.455	16.566	18.391	20.012	
SN716.095	0187	0.95	6.094	9.584	11.689	13.441	16.332	18.718	20.780	22.611	
SN716.100	0213	1.00	6.939	10.915	13.311	15.307	18.600	21.317	23.664	25.750	
SN716.110	0258	1.10	8.397	13.207	16.107	18.522	22.505	25.793	28.634	31.158	
SN716.120	0307	1.20	9.993	15.717	19.168	22.042	26.783	30.696	34.077	37.080	
SN716.130	0361	1.30	11.728	18.446	22.496	25.869	31.433	36.025	39.993	43.518	
SN716.140	0418	1.40	13.601	21.393	26.090	30.002	36.455	41.780	46.382	50.470	
SN716.150	0480	1.50	15.614	24.558	29.950	34.441	41.849	47.962	53.245	57.938	
SN716.160	0546	1.60	17.765	27.942	34.077	39.187	47.615	54.570	60.581	65.920	
SN716.170	0617	1.70	20.055	31.544	38.470	44.238	53.753	61.605	68.390	74.418	
SN716.180	0692	1.80	22.484	35.364	43.129	49.596	60.263	69.066	76.673	83.431	
SN716.190	0771	1.90	25.051	39.402	48.054	55.259	67.144	76.953	85.428	92.958	
SN716.200	0854	2.00	27.758	43.659	53.245	61.229	74.398	85.266	94.658	103.001	
SN716.210	0941	2.10	30.603	48.134	58.703	67.505	82.024	94.006	104.360	113.558	
SN716.220	1103	2.20	35.856	56.397	68.780	79.093	96.104	110.143	122.274	133.052	
SN716.230	1205	2.30	39.190	61.641	75.175	86.447	105.040	120.384	133.643	145.422	
SN716.240	1313	2.40	42.672	67.117	81.854	94.127	114.372	131.080	145.517	158.343	
SN716.250	1424	2.50	46.302	72.827	88.817	102.135	124.102	142.230	157.896	171.813	
SN716.260	1540	2.60	50.080	78.770	96.064	110.469	134.228	153.836	170.780	185.833	

SAPPHIRE NOZZLE SN716

ART. NO	NOZZLE SIZE IN US GAL/MIN AT 40°PSI	NOZZLE ØD MM	PRESSURE IN PSI / BAR							
			psi 2900	psi 7250	psi 10875	psi 14500	psi 21750	psi 29000	psi 36250	psi 43500
			bar 200	bar 500	bar 750	bar 1000	bar 1500	bar 2000	bar 2500	bar 3000
			FLOW RATE IN L/MIN							
SN716.270	1661	2.70	54.007	84.945	103.596	119.130	144.752	165.898	184.170	200.402
SN716.280	1786	2.80	58.081	91.354	111.412	128.118	155.673	178.414	198.064	215.522
SN716.290	1917	2.90	62.304	97.996	119.512	137.432	166.991	191.385	212.465	231.191
SN716.300	2051	3.00	66.675	104.871	127.896	147.074	178.707	204.812	227.370	247.410

INSTRUCTIONS

WHEN MANUALLY OPERATING HIGH PRESSURE GUNS AND LANCES THE REPULSIVE FORCE ON THE AXIS SHOULD NOT EXCEED 250N! IF THE REPULSIVE FORCE EXCEEDS 150N, A SUPPORT / BODY ARMOUR IS REQUIRED!

	< 150 N
	< 250 N
	> 250 N



Jan van der Heijdenstraat 44
3261 LE Oud-Beijerland
The Netherlands

T +31 186 62 14 84
info@salotech.nl
www.salotech.nl