

# SAPPHIRE NOZZLE 976

The high-performance Sapphire nozzle type 976 is designed for surface treatment. The nozzle is characterized above all by its service life, efficiency and quality. This nozzle was designed for the rotary nozzle Barracuda® from Stoneage.

The heart of the nozzle, its the sapphire has a consistent and high quality. All sapphire are checked for scratches, cracks and flow.

This product is compatible with the following brands or products.  
- OS7™

## PROPERTIES AND ADVANTAGES

- LONG LIFETIME
- CONSTANT JET QUALITY
- HIGH-POWER AND FOCUSED WATER JET
- NEEDLE JET WITH HIGH ENERGY DENSITY
- EASY TO INSTALL AND DISASSEMBLE
- SWISS QUALITY

## APPLICATIONS

- CONSTRUCTION INDUSTRY
- MINING
- CONCRETE DEMOLITION
- SURFACE TREATMENT
- CEMENT AND CONCRETE INDUSTRY
- INDUSTRIAL CLEANING
- SPRAYBARS

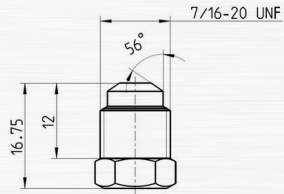
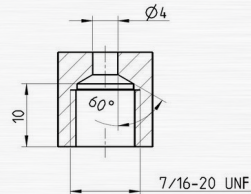

| CHARACTERISTICS          | TYPE      |
|--------------------------|-----------|
|                          |           |
| Operating pressure (bar) | max. 3000 |
| Operating temp. (°C)     | max. 150° |
| Tightening torque (Nm)   | max. 40°  |

# SAPPHIRE NOZZLE 976

## PERFORMANCES

| ART. NO            | NOZZLE SIZE IN US GAL/MIN AT 40 PSI | NOZZLE ØD MM | PRESSURE IN PSI / BAR |        |        |         |         |         |         |         |     |
|--------------------|-------------------------------------|--------------|-----------------------|--------|--------|---------|---------|---------|---------|---------|-----|
|                    |                                     |              | psi                   | psi    | psi    | psi     | psi     | psi     | psi     | psi     | psi |
|                    |                                     |              | 2900                  | 7250   | 10875  | 14500   | 21750   | 29000   | 36250   | 43500   |     |
|                    |                                     |              | bar                   | bar    | bar    | bar     | bar     | bar     | bar     | bar     | bar |
|                    |                                     |              | 200                   | 500    | 750    | 1000    | 1500    | 2000    | 2500    | 3000    |     |
| FLOW RATE IN L/MIN |                                     |              |                       |        |        |         |         |         |         |         |     |
| SN716.010          | 0002                                | 0.10         | 0.064                 | 0.100  | 0.122  | 0.141   | 0.171   | 0.196   | 0.217   | 0.237   |     |
| SN716.0125         | 0003                                | 0.125        | 0.100                 | 0.157  | 0.191  | 0.220   | 0.267   | 0.306   | 0.340   | 0.370   |     |
| SN716.015          | 0004                                | 0.15         | 0.143                 | 0.226  | 0.275  | 0.316   | 0.385   | 0.441   | 0.489   | 0.532   |     |
| SN716.0175         | 0006                                | 0.175        | 0.195                 | 0.307  | 0.375  | 0.431   | 0.523   | 0.600   | 0.666   | 0.725   |     |
| SN716.020          | 0008                                | 0.20         | 0.255                 | 0.401  | 0.489  | 0.563   | 0.684   | 0.784   | 0.870   | 0.946   |     |
| SN716.025          | 0012                                | 0.25         | 0.399                 | 0.627  | 0.764  | 0.879   | 1.068   | 1.224   | 1.359   | 1.479   |     |
| SN716.030          | 0018                                | 0.30         | 0.574                 | 0.903  | 1.101  | 1.266   | 1.538   | 1.763   | 1.957   | 2.130   |     |
| SN716.035          | 0025                                | 0.35         | 0.804                 | 1.265  | 1.542  | 1.774   | 2.155   | 2.470   | 2.742   | 2.984   |     |
| SN716.040          | 0032                                | 0.40         | 1.050                 | 1.652  | 2.015  | 2.317   | 2.815   | 3.226   | 3.582   | 3.897   |     |
| SN716.045          | 0041                                | 0.45         | 1.329                 | 2.091  | 2.550  | 2.932   | 3.563   | 4.083   | 4.533   | 4.933   |     |
| SN716.050          | 0050                                | 0.50         | 1.641                 | 2.581  | 3.148  | 3.620   | 4.399   | 5.041   | 5.596   | 6.090   |     |
| SN716.055          | 0061                                | 0.55         | 1.986                 | 3.123  | 3.809  | 4.380   | 5.322   | 6.100   | 6.772   | 7.368   |     |
| SN716.060          | 0073                                | 0.60         | 2.363                 | 3.717  | 4.533  | 5.213   | 6.334   | 7.259   | 8.059   | 8.769   |     |
| SN716.065          | 0085                                | 0.65         | 2.773                 | 4.362  | 5.320  | 6.118   | 7.434   | 8.519   | 9.458   | 10.291  |     |
| SN716.070          | 0099                                | 0.70         | 3.217                 | 5.059  | 6.170  | 7.095   | 8.621   | 9.881   | 10.969  | 11.936  |     |
| SN716.075          | 0114                                | 0.75         | 3.692                 | 5.808  | 7.083  | 8.145   | 9.897   | 11.342  | 12.592  | 13.702  |     |
| SN716.080          | 0131                                | 0.80         | 4.261                 | 6.702  | 8.174  | 9.399   | 11.421  | 13.090  | 14.531  | 15.812  |     |
| SN716.085          | 0148                                | 0.85         | 4.810                 | 7.566  | 9.228  | 10.611  | 12.893  | 14.777  | 16.404  | 17.850  |     |
| SN716.090          | 0166                                | 0.90         | 5.393                 | 8.483  | 10.345 | 11.896  | 14.455  | 16.566  | 18.391  | 20.012  |     |
| SN716.095          | 0187                                | 0.95         | 6.094                 | 9.584  | 11.689 | 13.441  | 16.332  | 18.718  | 20.780  | 22.611  |     |
| SN716.100          | 0213                                | 1.00         | 6.939                 | 10.915 | 13.311 | 15.307  | 18.600  | 21.317  | 23.664  | 25.750  |     |
| SN716.110          | 0258                                | 1.10         | 8.397                 | 13.207 | 16.107 | 18.522  | 22.505  | 25.793  | 28.634  | 31.158  |     |
| SN716.120          | 0307                                | 1.20         | 9.993                 | 15.717 | 19.168 | 22.042  | 26.783  | 30.696  | 34.077  | 37.080  |     |
| SN716.130          | 0361                                | 1.30         | 11.728                | 18.446 | 22.496 | 25.869  | 31.433  | 36.025  | 39.993  | 43.518  |     |
| SN716.140          | 0418                                | 1.40         | 13.601                | 21.393 | 26.090 | 30.002  | 36.455  | 41.780  | 46.382  | 50.470  |     |
| SN716.150          | 0480                                | 1.50         | 15.614                | 24.558 | 29.950 | 34.441  | 41.849  | 47.962  | 53.245  | 57.938  |     |
| SN716.160          | 0546                                | 1.60         | 17.765                | 27.942 | 34.077 | 39.187  | 47.615  | 54.570  | 60.581  | 65.920  |     |
| SN716.170          | 0617                                | 1.70         | 20.055                | 31.544 | 38.470 | 44.238  | 53.753  | 61.605  | 68.390  | 74.418  |     |
| SN716.180          | 0692                                | 1.80         | 22.484                | 35.364 | 43.129 | 49.596  | 60.263  | 69.066  | 76.673  | 83.431  |     |
| SN716.190          | 0771                                | 1.90         | 25.051                | 39.402 | 48.054 | 55.259  | 67.144  | 76.953  | 85.428  | 92.958  |     |
| SN716.200          | 0854                                | 2.00         | 27.758                | 43.659 | 53.245 | 61.229  | 74.398  | 85.266  | 94.658  | 103.001 |     |
| SN716.210          | 0941                                | 2.10         | 30.603                | 48.134 | 58.703 | 67.505  | 82.024  | 94.006  | 104.360 | 113.558 |     |
| SN716.220          | 1103                                | 2.20         | 35.856                | 56.397 | 68.780 | 79.093  | 96.104  | 110.143 | 122.274 | 133.052 |     |
| SN716.230          | 1205                                | 2.30         | 39.190                | 61.641 | 75.175 | 86.447  | 105.040 | 120.384 | 133.643 | 145.422 |     |
| SN716.240          | 1313                                | 2.40         | 42.672                | 67.117 | 81.854 | 94.127  | 114.372 | 131.080 | 145.517 | 158.343 |     |
| SN716.250          | 1424                                | 2.50         | 46.302                | 72.827 | 88.817 | 102.135 | 124.102 | 142.230 | 157.896 | 171.813 |     |
| SN716.260          | 1540                                | 2.60         | 50.080                | 78.770 | 96.064 | 110.469 | 134.228 | 153.836 | 170.780 | 185.833 |     |

# SAPPHIRE NOZZLE 976

| ART. NO   | NOZZLE SIZE IN US GAL/MIN AT 40PSI | NOZZLE ØD MM | PRESSURE IN PSI / BAR |         |         |         |         |         |         |         |
|-----------|------------------------------------|--------------|-----------------------|---------|---------|---------|---------|---------|---------|---------|
|           |                                    |              | psi                   | psi     | psi     | psi     | psi     | psi     | psi     | psi     |
|           |                                    |              | 2900                  | 7250    | 10875   | 14500   | 21750   | 29000   | 36250   | 43500   |
|           |                                    |              | bar                   | bar     | bar     | bar     | bar     | bar     | bar     | bar     |
|           |                                    |              | FLOW RATE IN L/MIN    |         |         |         |         |         |         |         |
|           |                                    |              | 200                   | 500     | 750     | 1000    | 1500    | 2000    | 2500    | 3000    |
| SN716.270 | 1661                               | 2.70         | 54.007                | 84.945  | 103.596 | 119.130 | 144.752 | 165.898 | 184.170 | 200.402 |
| SN716.280 | 1786                               | 2.80         | 58.081                | 91.354  | 111.412 | 128.118 | 155.673 | 178.414 | 198.064 | 215.522 |
| SN716.290 | 1917                               | 2.90         | 62.304                | 97.996  | 119.512 | 137.432 | 166.991 | 191.385 | 212.465 | 231.191 |
| SN716.300 | 2051                               | 3.00         | 66.675                | 104.871 | 127.896 | 147.074 | 178.707 | 204.812 | 227.370 | 247.410 |

## INSTRUCTIONS

WHEN MANUALLY OPERATING HIGH PRESSURE GUNS AND LANCES THE REPULSIVE FORCE ON THE AXIS SHOULD NOT EXCEED 250N! IF THE REPULSIVE FORCE EXCEEDS 150N, A SUPPORT / BODY ARMOUR IS REQUIRED!

|  |         |
|--|---------|
|  | < 150 N |
|  | < 250 N |
|  | > 250 N |



Jan van der Heijdenstraat 44  
3261 LE Oud-Beijerland  
The Netherlands

T +31 186 62 14 84  
info@salotech.nl  
www.salotech.nl